



Senior's Camp

Speaker: Jake Froese

Music: Sadie Peters

August 30 - September 4, 2009

Camp opens for registration
Sunday at 1:00 pm.
Summer Celebration Program
starts at 3:00 pm

Mail registration to:
Gimli Bible Camp
Box 1579
Gimli, MB ROC 1B0

Activities

Games (5 pin bowling, lawn bowling, shuffleboard, jigsaw puzzles, crokinole, camp fire, horseshoes)
Historical walking tour of Gimli
Orchestra (bring your instrument)
Choir (male, female, mixed)
Tuck Shop

An offering will be taken for the camp
Sunday and Thursday

Our speaker—Jake Froese

*Has been the Pastor of ~
~Blumenhof Gospel Church ~ south of
Swift Current, SK (almost 4 years)
~Wynyard Gospel Church ~ Wynyard, SK
(3 years)
~Morrow Gospel Church ~ Winnipeg, MB
(14 years)
~Christian Fellowship Chapel ~ Winnipeg, MB
~Served with the Canadian office of Back
to the Bible as Biblical Counsellor and in
Public Ministries (almost 19 years)
~Presently - continuing in Pulpit Supply
Ministry, visitation, etc.
~Married to Lena for 48 years. Resides in
Winnipeg.
~Has 3 sons, 3 daughter in laws, 12
grandchildren.*

Remember to bring bedding, pillow,
toiletries, bible, notebook, bug spray,
games, and stories to share with your
friends.
Please help with coffee and snack
times and bring a dozen of your
favourite cookies to share with the
group.
Bring your voices and musical
instruments for a week of praise and
worship.

Camper Name(s) _____

Address _____

City _____ Postal Code _____

Phone _____ Cell Phone _____

Email Address _____

Accommodations: (see reverse)

Room number: _____

Bringing own trailer: _____

Any Special needs? _____

Deposit enclosed

\$25.00 per person

Full amount

\$95.00 per person

Holding forth the Word of Life since 1928

Seniors cabins

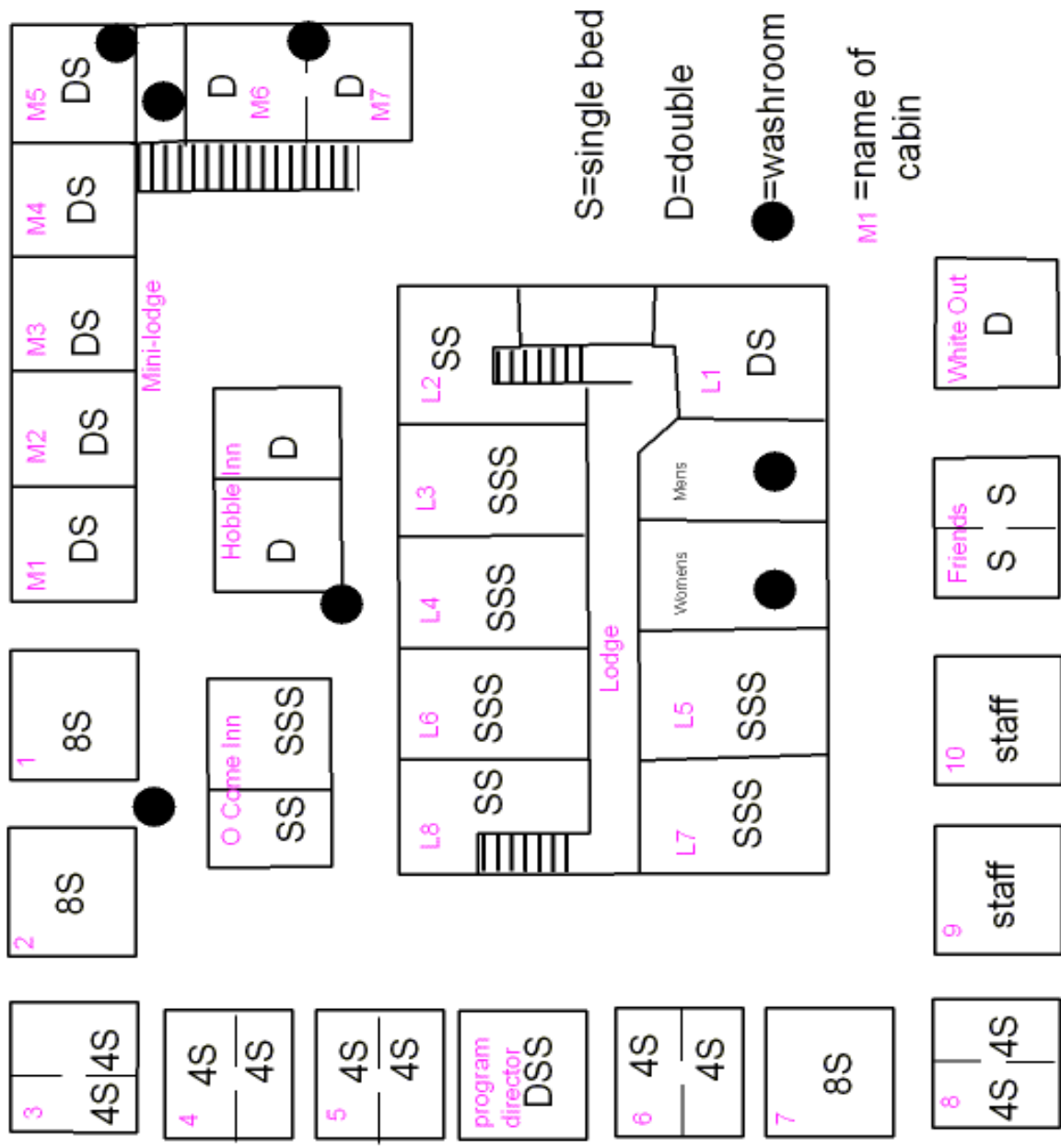

Because kids are worth it!

Accommodations will be first-come, first served but we will work to ensure that everyone's physical needs are met. Please choose our cabin (1-9) accommodations if you are physically able.

The mini lodge (11-17) has a ramp and an outside washroom. Please save these rooms for those who physically require them and can no longer climb stairs.

The lodge rooms (21-28) are above the main meeting and dining area and have indoor washrooms. Pray that the health of our friends will remain strong so we'll all be able to meet again this year.

